

PROFESSIONAL LIGHTING



# XENOLUX

250 | 500 | 1000 | 1500

MADE IN GERMANY



**Multiblitz**



**VERSATILE – INGENIOUS – XENOLUX!**

Whoever wishes to bring light into digital photography these days needs bright ideas, lots of talent, an outstanding camera – and XENOLUX by Multiblitz.

Be it still life, people or industrial photography or portraiture; be it in the studio or on location – there will always be light with XENOLUX. These extremely compact studio flash units are available in versions with 250 | 500 | 1000 | 1500 Ws. But that alone doesn't make them ideal partners for all kinds of digital photography. Their versatility and functionality makes these ergonomically designed studio flash units ideal

companions on all your shoots. Their easy-to-read control panel, for example, allows you vary light output over five f-stops. Brief recycling times with a minimum 0.4 s and flash durations up to 1/2100 s are possible. The built-in photocell has two sensitivity settings to allow for small rooms just as easily as for outdoor working conditions. Color temperature is stabilized\*. Additional useful features are plug-in flash tubes and a halogen focusing light of 250 to 650 W with separate proportionality. All flash units are fitted with the time-tried patented V-type bayonet mount giving access to our extensive line of light formers.

As sophisticated as the XENOLUX series may be, our engineers have not forgotten to make it highly comfortable as well: Its cooling fan is hardly audible, and it can be totally remote-controlled by wireless. Typically Multiblitz!

“Enlighten“ yourself and visit us at [www.multiblitz.de](http://www.multiblitz.de)



**Multiblitz**

\* XENOLUX 1000 and XENOLUX 1500



## ALL YOU NEED – INDOORS OR OUT

If you wish to follow spontaneous ideas in the studio or have to cope with rapidly changing lighting conditions on location, all you have to do is turn to your personal XENOLUX set.

We have assembled custom sets for all kinds of photography and shooting conditions, distinguishing between Location Sets with two flash units and Comfort Sets with three.

### XENOKOM Comfort Sets

- 3 Flash units, ready to use
- 3 Folding stands
- 1 Brolly
- 1 Umbrella reflector
- 1 Honeycomb reflector
- 1 Honeycomb filter
- 1 Soft box 65 x 65 cm
- 1 Sync cable
- 1 Aluminum case or nylon bag

#### Equipped with:

- 3 x XENOLUX 250 = XENOKOM - 2
- 3 x XENOLUX 500 = XENOKOM - 5
- 3 x XENOLUX 1000 = XENOKOM - 10
- 3 x XENOLUX 1500 = XENOKOM - 15

XENOKOM -10 and -15 without lighting stands and honeycomb filters!



XENOKOM  
Comfort Set

### The Comfort Sets

Each XENOKOM Comfort Set comes with three flash units of identical power, such as three XENOLUX 1000 or three XENOLUX 1500. In addition to a reflector taking one of three different honeycomb filters, the set includes a protective and umbrella reflector with brolly reflector and a soft box.

Apart from having access to the extensive line of Multiblitz light formers, the XENOKOM-2 and 5 Sets come with three lighting stands each. With XENOKOM-2, 5 and 10 Sets you may choose between a rugged aluminum case or a robust nylon bag.

And what's special about the nylon bag: It has wheels so that you can easily pull your Comfort Set behind you. Indoors or out.

### XENOKIT 2+5 Location Sets

- 2 Flash units, ready to use
- 2 Folding stands
- 1 Honeycomb reflector
- 3 Honeycomb filters (small, medium, large)
- 1 Soft box, 65 x 65 cm
- 1 Sync cable
- 1 Nylon bag

#### Equipped with:

- 2 x XENOLUX 250 = XENOKIT - 2
- 2 x XENOLUX 500 = XENOKIT - 5



XENOKIT Location Set

### The Location Sets

XENOKIT-2:  
with two XENOLUX 250 units

XENOKIT-5:  
with two XENOLUX 500 units

The two sets come with all necessary lamps and cables in a rugged bag. Any set of flash units is just as good as the light formers that come with it. This is why a number of suitable light formers are supplied with each Location Set. These include not only reflectors but, for example, three different honeycomb filters. Each Location Set also includes two lighting stands and a soft box for uniform illumination.

MADE IN GERMANY



## NO MORE OBSTACLES

You are tired of cable-kinks and signal interference from infrared remote controls? We have the solution: the Multiblitz Wireless Remote Control.

Walls, corners, partitions – obstacles that may cause conventional infrared remotes to give less than satisfactory performance. Our wireless remote control, however, is not thrown off guard by this type of obstacles.

On the contrary: Its functionality and power are so convincing you'll never want to go without it any more.

Our Wireless Remote gives access to functions that go even beyond those of the XENOLUX units:

- Modeling light adjustable independently of flash output.
- Free choice of flash monitoring: Without, acoustic or optical, acoustic and optical.

Up to 10 units can be controlled with a range of 30 m in interiors and 100 m outdoors. And this not only applies to compact XENOLUX units, but to future Multiblitz series as well.

What's more, our Wireless Remote communicates with the flash units – and vice versa, making sure that all commands are positively executed, or there is immediate feedback.

Via a USB interface, our Wireless Remote also allows all functions to be controlled from your computer. The software supplied will run on both Windows and Macintosh computers. The multitasking device will easily let you save important projects and complex flash settings.

In other words, a genuine Multiblitz product leaving nothing to chance.



RADIO SLAVE  
RS<sup>2</sup>

- Extra-small radio trigger system with 16 channels
- Compatible with all commercial flash units
- Indoor range approx. 30 m, outdoor range approx. 100 m
- More than 100.000 trigger cycles (300 hrs. stand-by)

### Soft disks

Heat-resistant, for RISOF-2 / RISOF-3 standard reflectors

### Barn doors

For standard reflectors; integral filter holder, four doors  
RISAB-24 / RISAB-34

### Honeycomb reflector

65°, 18cm ø, LUNOS

### Standard reflector

65°, 50° silver or white reflecting surface  
RINOS-2 / RINOW-2  
RINOS-3 / RINOW-3

### Honeycomb filters

Various sizes (Small, medium, large)  
RIWAN-2S, M, L  
RIWAN-3S, M, L

### Umbrella reflectors

White (80 cm ø) or silvery white, reversible (110 cm ø)  
VARES / VAREU

### Fresnel attachment

With integral iris diaphragm  
RASTU

### Snoot

With honeycomb insert  
STUSCH + RIBUS

### Background reflector

Bevelled, with filter holder  
RIVER

### Soft-light reflector

White, with counterreflector  
RIWEW

### Lightball

360° surround light  
RIGLOB

### Narrow-beam reflector

35°, RIENG

### Wide-angle reflector

120°, RIWEI

### Beauty reflector

for people-, fashion und beauty-photography (44 cm ø)  
Honeycomb reflector (13 cm ø)  
RIBEAU





## THE CONTROL PANEL

### FORM FOLLOWS FUNCTION

This design principle undoubtedly applies to the new XENOLUX control panel. The brand-new wireless remote control makes working with XENOLUX even more comfortable. Via a USB interface, all functions can even be controlled from your computer.

- 1 Brilliant display reading to 1/10<sup>th</sup> f-stop
- 2 Infinitely variable flash output with halogen light
- 3 Reduction of photocell sensitivity
- 4 Photocell ON/OFF
- 5 Optical/acoustic flash monitor
- 6 Open-flash button
- 7 High-sensitivity photocell with integral IR receiver
- 8 Halogen light proportional or 100%
- 9 Halogen light proportional to flash output over entire XENOLUX Series
- 10 Halogen light ON / OFF
- 11 XENOLUX ON / OFF



## XENOLUX AT A GLANCE

### THE NEW XENOLUX SERIES IN FOUR POWER VERSIONS

With the large V-type bayonet and – with 250 to 1500 Ws – tailored for the present-day needs of digital photographers. Custom sets to suit different requirements in all areas of modern photography.



#### XENOLUX 250

Enter the world of XENOLUX with sufficient power for work in the studio and on location.

#### XENOLUX 500

The allrounder, especially for portrait work, with lots of power and handy proportions, also well-suited for work on location. Flash output variable from 500 to 30 Ws.

#### XENOLUX 1000

Take the next step to professional digital photography with XENOLUX 1000. Even more power, but still handy, for easy use in stills, industrial or people photography.

#### XENOLUX 1500

The top model of the XENOLUX Series. 1500 Ws – power to spare! Whether in your studio or on location, the XENOLUX flagship is equally at home in all fields of modern photography.

## XENOLUX FACTS

- + MIN. RECYCLING TIME 0.4 S
- + MIN. FLASH DURATION 1/2100 S
- + STABILIZED COLOR TEMPERATURE\*
- + AUTODUMPING
- + INFINITELY VARIABLE FLASH OUTPUT
- + HALOGEN LIGHT PROPORTIONAL WITH 250 W (SERVICE LIFE 2000 H) OR 650 W
- + VARIABLE PHOTOCELL SENSITIVITY
- + ACOUSTIC OR OPTICAL FIRING MONITOR
- + KITS WITH TWO OR THREE FLASH UNITS IN RUGGED, PADDED CARRYING BAGS OR ALUMINUM CASES

\* XENOLUX 1000 and XENOLUX 1500



## MADE IN GERMANY

# EQUIPMENT OVERVIEW

## MULTIBLITZ LIGHT FORMERS AND ACCESSORIES

### Uncompromising quality and versatility

Multiblitz accessories are guaranteed to set the right accents. Their time-tried V-type die-cast metal bayonet makes for rapid changing. Soft boxes and strip lights, including fully rotatable versions (360°).

Plus a host of small and large aids for any purpose, both in the studio and on location.

- |    |              |    |                               |
|----|--------------|----|-------------------------------|
| 1  | XENOLUX 250  | 38 | LUWAN-M                       |
| 2  | XENOLUX 500  | 39 | LUWAN-L                       |
| 3  | XENOLUX 1000 | 40 | LUFEX-65                      |
| 4  | XENOLUX 1500 | 41 | VATHRU                        |
| 5  | LUHAL-3      | 42 | VARES                         |
| 6  | STUROW       | 43 | VAREU                         |
| 7  | VAJOG        | 44 | RIMUL-51                      |
| 8  | RAREW        | 45 | COMWAL-1                      |
| 9  | LUKLA-1      | 46 | RIFLAP -80/-100/<br>-110/-140 |
| 10 | LUKAP        | 47 | RIFOC-120                     |
| 11 | RASTU        | 48 | RIFOC-150                     |
| 12 | RIENG        | 49 | RIFOC-213                     |
| 13 | RIWANG-S     | 50 | RIFOC-254                     |
| 14 | RIWANG-M     | 51 | RIGLOB                        |
| 15 | RIWANG-L     | 52 | RESBO-S                       |
| 16 | RINOS-2      | 53 | RESBO-M                       |
| 17 | RINOW-2      | 54 | RIREC-60                      |
| 18 | RIWAN-2S     | 55 | RIREC-80                      |
| 19 | RIWAN-2M     | 56 | PROTUR FOR RIREC-60           |
| 20 | RIWAN-2L     | 57 | RECWAN-60/-80                 |
| 21 | RIVER        | 58 | RIFEX-80                      |
| 22 | RISAB-24     | 59 | RIFEX-110                     |
| 23 | RISOF-2      | 60 | RITUR-80/-110                 |
| 24 | RINOW-3      | 61 | FEXWAN-80/-110                |
| 25 | RINOS-3      | 62 | RIRIP-30                      |
| 26 | RIWAN-3S     | 63 | RECWAN-30                     |
| 27 | RIWAN-3M     | 64 | XENOTRA                       |
| 28 | RIWAN-3L     | 65 | XENOBAG                       |
| 29 | RISAB-34     | 66 | STUBAG                        |
| 30 | RISOF-3      | 67 | VATRA-3                       |
| 31 | RIWEI        | 68 | MAO52BBLM                     |
| 32 | RIWEW        | 69 | VANET                         |
| 33 | RIBEAU       | 70 | MASYG                         |
| 34 | STUSCH       | 71 | RADIO SLAVE-RS2               |
| 35 | RIBUS        | 72 | LUXREM-T                      |
| 36 | LUNOS        | 73 | LUXREM-R                      |
| 37 | LUWAN-S      |    |                               |

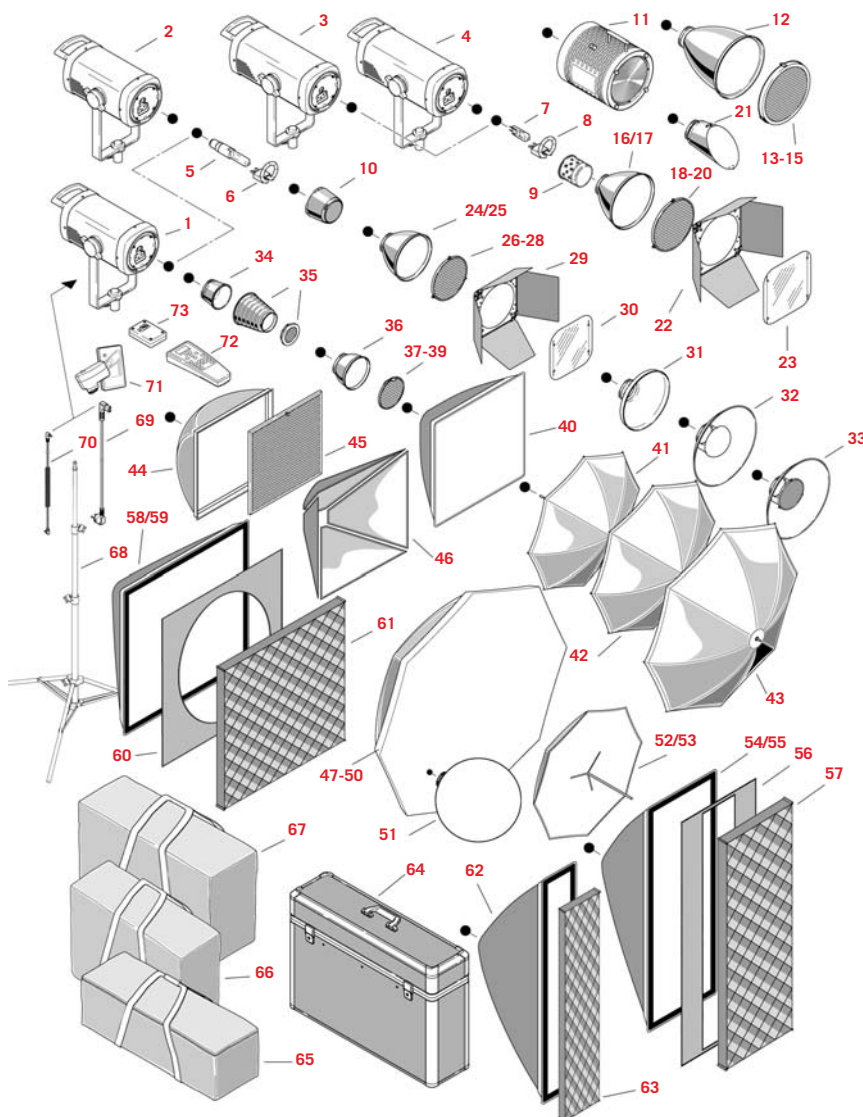

XENOLUX Specifications		250	500	1000	1500
Flash output	~J(Ws)	250	500	1000	1500
Power supply	V	220-240			
Aperture, 1m, ISO 100	Ref.	45.8	64.8	90.9	128.4
Guide No, 1m, ISO 100	RINOS-2/50°	60	85	123	147
Control range		5 f-stops			
1/10 increments	~J(Ws)	15-250	30-500	60-1000	100-1500
Recycling time	sec	0.4-1.3	0.4-1.4	0.4-1.4	0.4-1.8
Flash duration t 0.5	sec	1/500- 1/850	1/1000- 1/2100	1/1300- 1/1200	1/1000- 1/1850
Flash tube, UV-absorbing, Code:		STUROW		RAREW	
Halogen modeling light 100%	W	250		650	
Halogen tube	W / V Typ	250 / 230 64479 AM (Osram) RH 250 TM (Radium)		650 / 240 64540 (Osram)	
Halogen modeling light, control range	W	15 - 250		40 - 650	
Flash triggering		photocell, sync cable, open-flash button, infrared trigger, LUXREM			
Voltage across sync cable	V	12			
Connected load	A/VA (W)	6.3/1500		10/2400	
Flash voltage stability	%	+/- 1			
Radio interference suppression		according to CE, DIN IEC 491, VDE 0882			
Dimensions	137 x 137mm	365		417	470
Length (without bracket)	(mm)	365		417	470
Weight	kg	2.8	3.1	3.9	4.6
Tolerances of specifications and components conforming to DIN and IEC standards. Subject to change without notice.					

YOUR DISTRIBUTOR:

# Multiblitz

FERDINAND - PORSCHE - STR. 19  
D-51149 KÖLN | GERMANY

FO: +49 (0)2203 - 93 96 35  
FAX: +49 (0)2203 - 93 96 49

E-MAIL: EXPORT@MULTIBLITZ.DE  
WWW.MULTIBLITZ.DE

# XENOLUX

250 | 500 | 1000 | 1500